

(CUSTOM LENGTHS AVAILABLE)

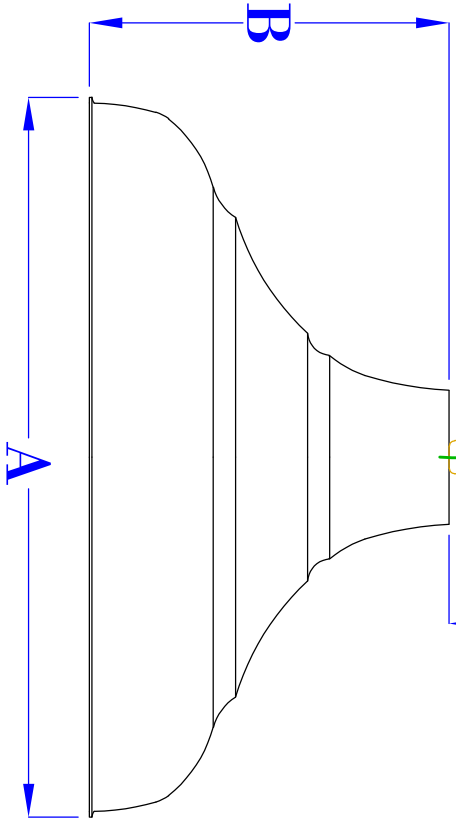

NOTES:

- 1. MOUNTING HARDWARE SUPPLIED BY OTHERS
- 2. FIXTURES ARE HANDCRAFTED. DIMENSIONS MAY VARY PLUS OR MINUS  $\frac{1}{4}$ "
- 3. ELECTRIC LIGHTS SUPPLIED WITH 18/2 WIRE WITH GROUND

FRONT VIEW  
(NTS)

5" DIAMETER CANOPY

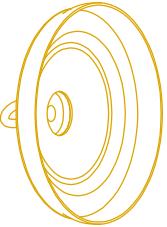

ISOMETRIC VIEW  
(NTS- BRACKET ONLY)

SIZE:	14"	16"	18"
A:	14"	16"	18"
B:	7"	8 $\frac{1}{8}$ "	8 $\frac{1}{2}$ "
C:	36"	36"	36"

BEVOLO GAS & ELECTRIC LIGHTS			
LIGHT:	WAREHOUSE DISTRICT	DATE:	JJG
BRACKET:	HANGING CHAIN	APP. BY:	JJG
		REVISION:	4
COPYRIGHT 2025, BEVOLO GAS & ELECTRIC LIGHTS. THIS DRAWING, AND ANY DESIGN OR DATA CONTAINED THEREIN ARE CONSIDERED PROPERTY OF BEVOLO GAS AND ELECTRIC LIGHTS. NEITHER THE DRAWING NOR ITS CONTENT MAY BE COPIED, REPRODUCED, OR EDITED TO A LIKENESS WITHOUT THE WRITTEN CONSENT OF BEVOLO GAS AND ELECTRIC LIGHTS.			